

# AstroAI

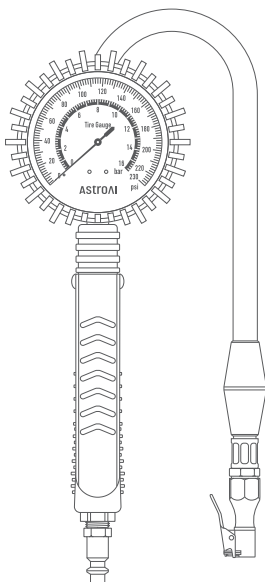

**GL-1411**

**TIRE PRESSURE INFLATOR GAUGE**

## **USER MANUAL**

# INTRODUCTION

Thank you for purchasing the AstroAI Tire Pressure Inflator Gauge.

This is a 3-in-1 tire pressure inflator gauge designed to measure tire pressure and inflate/deflate. This product is also equipped with a luminous screen and multiple accessories.

We hope you enjoy your new Tire Pressure Inflator Gauge!

Thank you again for choosing AstroAI, if you have any questions or concerns regarding your product, please contact us via **[support@astroai.com](mailto:support@astroai.com)**



Please fully read and follow this manual before using this product. Keep this manual for future reference.

## WARNING

- Please read and follow the instructions before use.
- Do not use the product for unintended purposes.
- Please do not use the product if it is defective.
- Keep the product out of children's reach. Do not expose the product to rain or water.
- Keep the product away from fire, corrosive liquids, and magnetic materials.
- The product is only compatible with Schrader Valves.
- Do not exceed the maximum pressure rating of the product.
- Do not modify this product in any capacity.
- Pay attention to the recommended pressure settings for tires. Do not exceed the recommended tire pressure, doing so may damage tires and vehicles, or cause bodily harm.
- When not in use please store the product in a dry place. Please only use a wet cloth and mild soap to clean the product.

# DIAGRAM

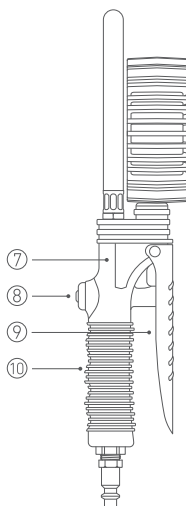
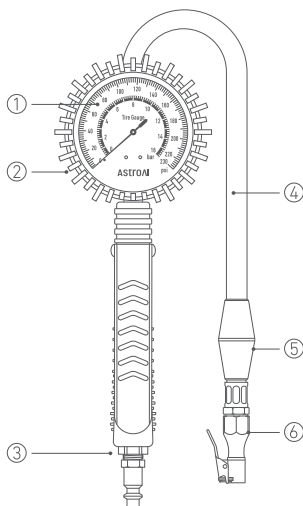

① Luminous screen

② Gauge protector

③ Quick-connect fitting

④ Hose

⑤ Air chuck protector

⑥ Air chuck

⑦ Handle

⑧ Air bleeder valve

⑨ Air valve trigger

⑩ Handle protector

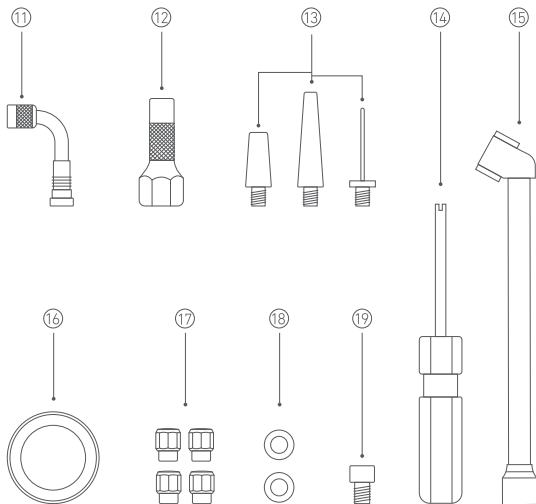

⑪ Motorcycle right-angle adapter

⑫ Brass twist-on chuck

⑬ Air nozzles

⑭ Tire stem screwdriver

⑮ Truck tire air chuck

⑯ Thread seal tape roll

⑰ Valve caps

⑱ Sealing ring

⑲ Presta to Schrader  
adapter

# AstroAI

Web: [www.astroai.com](http://www.astroai.com)

E-mail: [support@astroai.com](mailto:support@astroai.com)

## PRODUCT DIMENSIONS

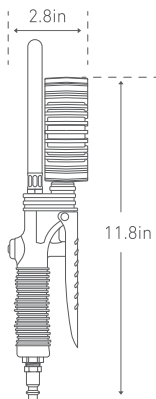
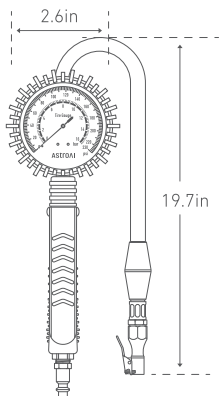

## SPECIFICATIONS

Inflation Range: 0-230 PSI, 0-16 bar

Accuracy:  $\pm 1\%$

Display Resolution: 2 PSI, 0.2bar

Display Type: Luminous screen

Measurement Units: PSI, bar

Compatibility: NPT Air compressor connector

# INSTRUCTIONS

Before starting, check the recommended inflation pressure for your vehicle's tires.

Manufacture-recommended pressures can be found on the inside of the driver's door jam and in the owner's manual.

The tire's maximum pressure can be located on the sidewall of the tire.

DO NOT exceed any maximum pressure ratings, doing so may damage tires and vehicles, or cause bodily harm.

## INFLATION

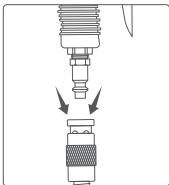

### 1. Connect to the air compressor

Attach the quick-connect fitting to the air compressor.

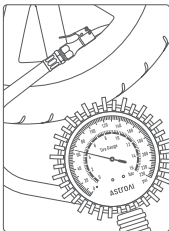

### 2. Connect to the tire

Remove the valve cap from the tire's valve stem, press the air chuck and connect it to the valve stem. (Press the air chuck tightly to avoid air leakage.)



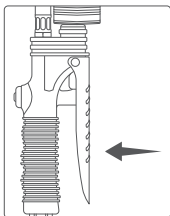

### 3. Inflation

Turn on the air compressor, press and hold the air valve trigger to start inflating the tire.

Release the air valve trigger when the desired value is reached on the dial. Then turn off the air compressor, remove the air chuck, and screw the tire stem cap back on.

## DEFLATION

- Remove the tire's valve stem cap.
- Connect the air chuck to the valve stem. (Press it tightly to avoid air leakage.)
- Press and hold the air bleeder valve to deflate.
- Release the air bleeder valve when the desired value is reached on the dial.
- Remove the air chuck and screw the tire stem cap back on.

## TROUBLESHOOTING

### Trouble: Inaccurate Reading

#### Solution

- Adjust the angle between the air chuck and the tire valve to ensure a tight seal.
- Small reading differences between gauges are normal. For large discrepancies, please contact us for help.

## **Trouble: Air Leaking**

### **Solution**

- It is normal for air to leak slightly when the chuck is connected and removed from the tire valve.
- Check if there is a tight seal between the chuck and tire valve.
- Adjust the angle between the air chuck and tire valve.
- Check all the connection points of the air compressor, inflator, quick-connect fitting, air chuck, and tire valve stem. All connection points should not leak; threads may require Teflon tape for a complete seal.
- Contact us for help.

## **WARRANTY PERIOD**

### **3-Year Limited Warranty From AstroAI**

Each AstroAI Tire Pressure Gauge with Inflator will be free from defects in material and workmanship.

This warranty does not cover damage from neglect, misuse, contamination, alteration, accident, or abnormal conditions of operation or handling. This warranty covers the original purchaser only and is not transferable.

AstroAI strives to provide our customers with excellent products and customer service.

Questions or concerns?

Please contact us at **[support@astroai.com](mailto:support@astroai.com)**. We're happy to help!